

14 August 1997

FILE

Please Quote: 6596111
6597116

Doc No: 66103

ROTORUA
DISTRICT
COUNCIL

«Name»
«Company»
«Address1»
Attn: «Address2»

Private Bag RO 3029
Rotorua
New Zealand
Telephone 07-348 4199
Fax 07-346 3143

Address all
communications to:
District Manager
Rotorua District Council

Dear Sir

CHANGE OF STREET NUMBERING

At the request of a Surveyor on behalf of his clients I have reallocated the street numbering for their proposed subdivisions.

Attached is a copy of the Scheme Plans with the new numbering and Council's file reference.

Could you please replace these with the ones originally sent.

Yours faithfully



Jane Thomsen
Admin Assistant

Name	Company	Address1	Address2
Telecom	PO Box 141	ROTORUA	Ian Hayes
Trustpower	Private Bag 12023	TAURANGA	Tania Grace
Natural Gas Corp	Private Bag	NEW PLYMOUTH	K Mathews
Land Information NZ	Private Bag 3028	HAMILTON	Grant Findlay

Doc No. 66105

MEMORANDUM FILE

DATE: 13/08/97

File Ref: 6596111/~~6597116~~

Doc Ref: **Error! Bookmark not defined.**

TO: Iris-Rates, Marama -Records, Greg-GIS, CPU

FROM: Jane Thomsen

SUBJECT: Change to allocated street numbering

I have had two requests from a Surveyor on behalf of their clients to amend the street numbering originally allocated to their proposed subdivisions. This has been approved, therefore could you please amend your records, or replace the original scheme plans issued, with the amended ones attached.

Regards

Jane Thomsen
Planning Services

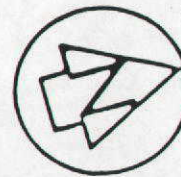

Subdivision file No. 6507116
Pavement Assessment: 6512/980

DEVON STREET
Public Road (20.12 wide)

REDUCED COPY
Not to scale shown

I, Peter Joughin Hawley, Registered Surveyor, hereby certify that this scheme plan has been prepared by me in accordance with the provisions of the Resource Management Act 1991.

P. Hawley 18/1/97.

TOTAL AREA: 931 m²

Note: Areas and measurements are subject to survey.

PROPOSED SUBDIVISION OF LOT 49 DP3178
BLOCK 1 TARAWERA SD ROTORUA DISTRICT
PREPARED FOR DAWSON FAMILY TRUST

Phipps Hawley Ltd.
REGISTERED SURVEYORS
20 Haupepe Street,
P.O. Box 190, Rotorua.
Phone (073) 478-995
Fax (073) 478-994



SCALE
1:200
DATE
DEC, 1996

DRAWING No.
2570 S
FB 206/15
JF4752

DPS 23421

50 DP3178

51 DP3178

48 DP3178

52 DP3178

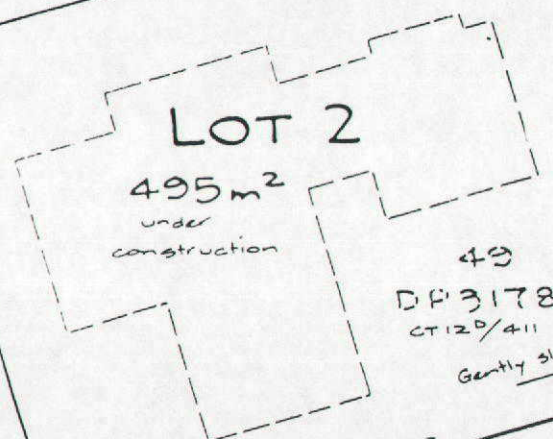

49 DP3178
CT 120/411

PROPOSED SEWAGE EASEMENT (2.0m wide) in favour of Lot 2
21.67
Proposed S & S Line

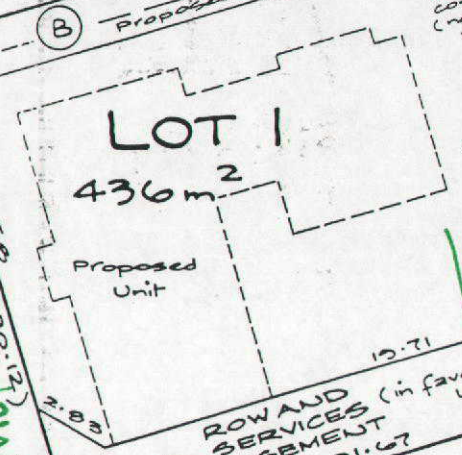

Now 26
water conn for Lot 1
Power box
conc 1/2

ROW AND SERVICES EASEMENT (in favour of Lot 2) 21.67

